

Series ITM

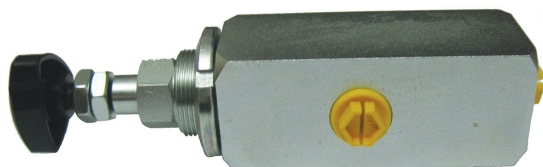

CHARACTERISTICS

Applications:

- Fuels or lubricant not corrosive.
- Maximum fluid temperature 150°C.
- Pressure adjustment by screw 5 - 30 bar.
- Manual pressure regulation.

FUNCTION and DIMENSIONS

ITM valve works as follow: the oil in the supply side “1” is under pressure and the piston keeps constant the pressure leading the oil through the hole in piston to return side “3”. The system pressure coming out from side “2” can be adjusted operating on the wheel.

Legend:

- 1 - Delivery
- 2 - Regulation
- 3 - Return

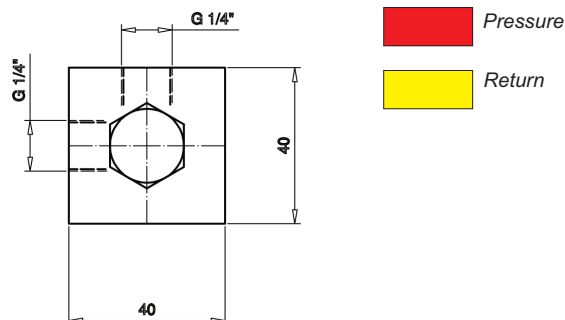
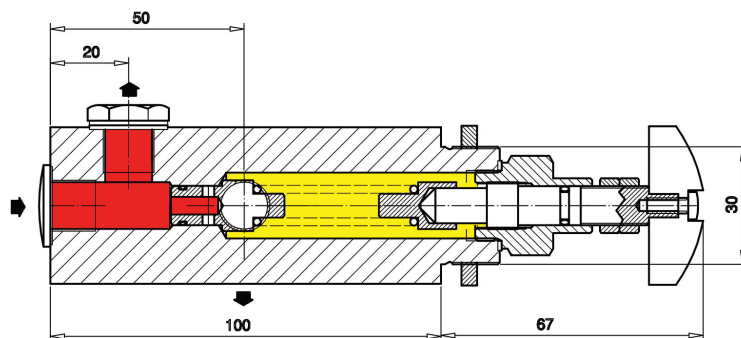
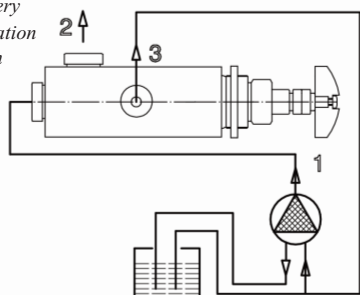

TECHNICAL DATA

Viscosity range	6 - 150 cSt
Pressure range	5 - 30 bar
Weight	1 kg
Max. oil temperature	150°C
Max. flow rate	1700 l/h

PRESSURE - CAPACITY DIAGRAM

