

BUTTERFLY GAS VALVE



Series ITGS



CHARACTERISTICS

Applications:

- Suitable gas hot air, natural gas, town gas, LPG and other non aggressive fuels.
- Low leakage rate and pressure loss.
- Possibility to mount any actuator chosen by the customer.
- Possibility to mount our suggested actuator.
- Low maintenance requirements.

FUNCTION

The butterfly valves series ITGS are designed for controlling the volume of gas to supply a modulating or two stage (progressive) burner.

DIMENSIONS OF THE VALVE

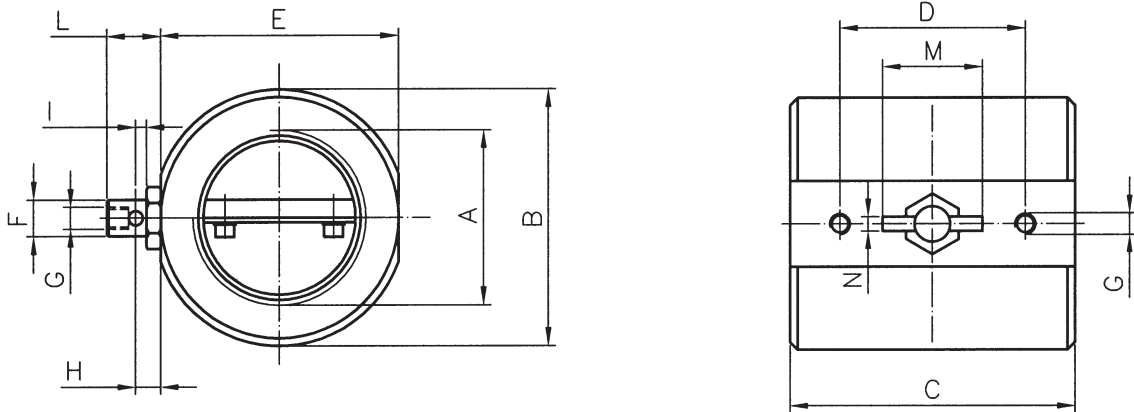

TYPE	A	B	C	D	E	F	G	H	I	L	M	N
DN 30	Rp 1"	55	70	52	52	10	M6	7	3	15	28	4
DN 40	Rp 1"1/2	70	80	52	66	10	M6	7	3	15	28	4
DN 50	Rp 2"	80	100	52	76	10	M6	7	3	15	28	4

IDENTIFICATION OF THE VALVE

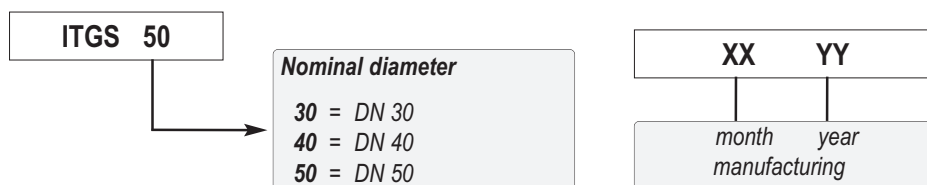
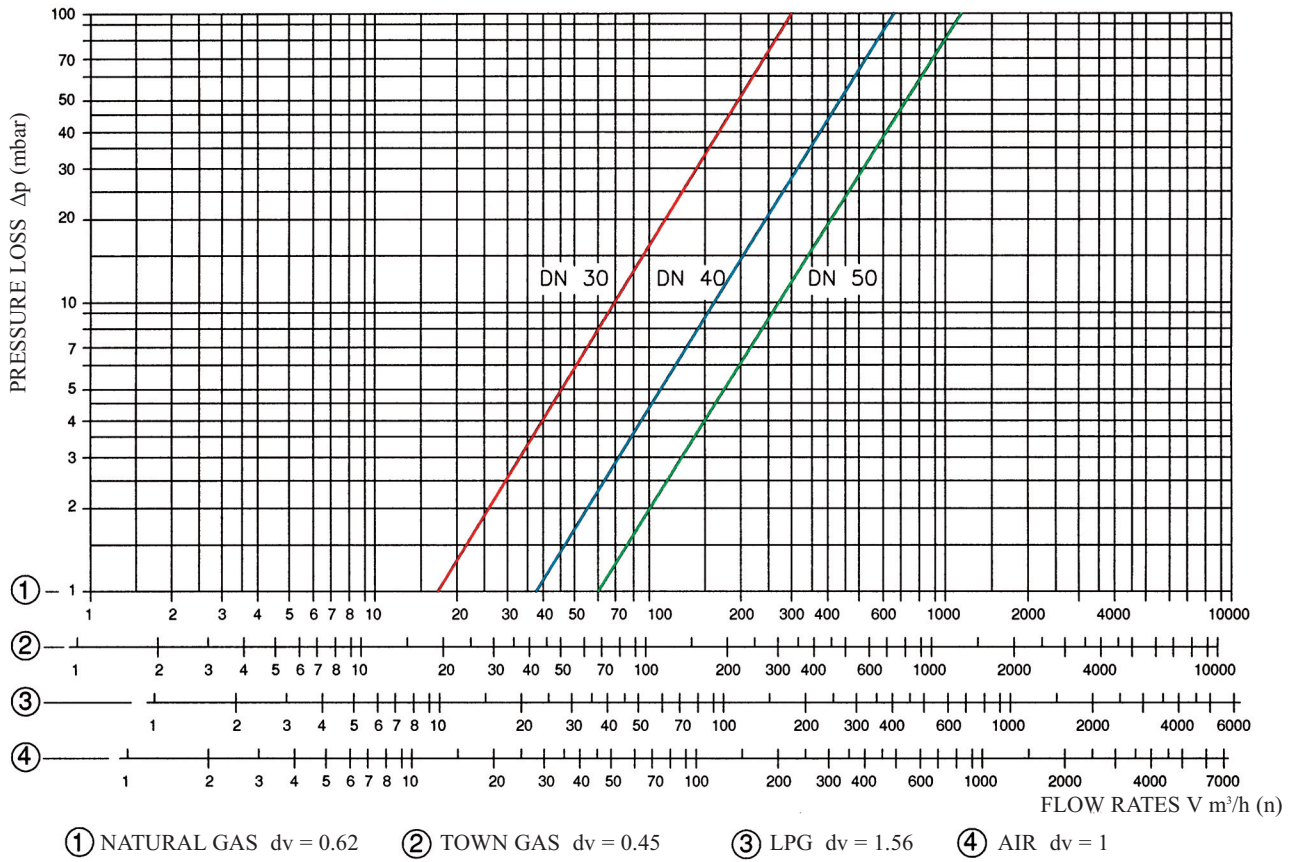

DIAGRAM OF THE VALVE

FULLY VALVE OPEN



APPLICATIONS WITH LEVER MECHANISM AND ACTUATOR

